



VT-M16x ... A2/M



VT-M16x ... A2

Technical Drawing

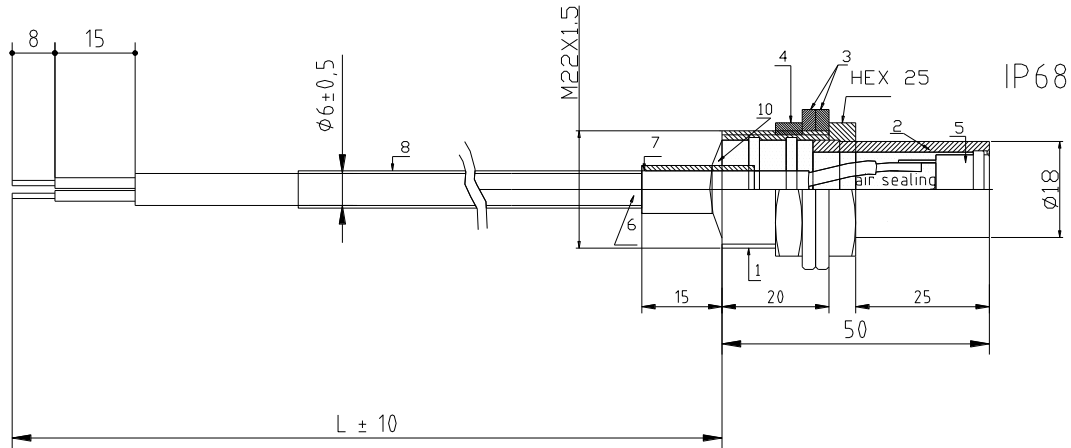

VT-M16x ... A2/M

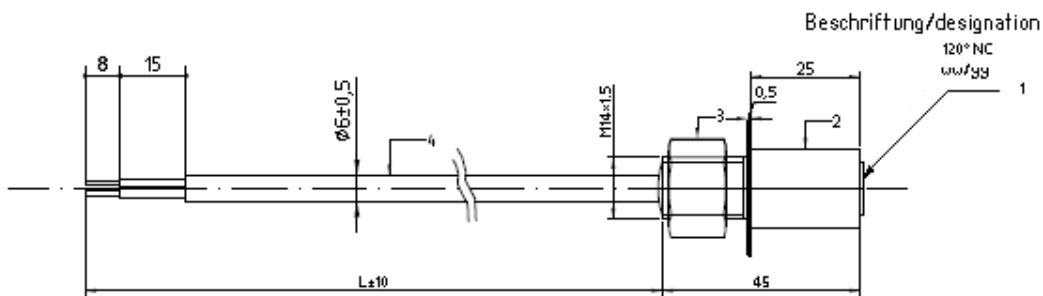

VT-M16x ... A2

Application

VT-M16x...A2/M e.g. A2 are thermostats that have been further developed into fire detectors. Designed specifically for the extreme conditions found in the engine compartment and with a protection class of IP68, these fire detectors are used in public transportation, aviation, rail and road transport to monitor the engine or other locations that have a high risk of fire.

Description

Based on the PTFE and Vigitherme Precision Thermostat design, these temperature sensors have a faster response time than leading competitors. They are gold-plated for TTL signal and are EMC narrowband (electric smog) emission-free. Approved by: NFC 93450 / UL 873.

Type A2/M is EN50155 approved for use in railway vehicles. Materials and components (PTFE, Brass, V2A) are resistant to corrosion and elemental damage, and are ideal for long-term exposure to harsh conditions in engine compartment. Shock and vibration resistant, this sensor can be used in land, air, and maritime vehicles.

Technical Data

Spot Fire Detectors VT-M16x ... A2/M & A2

Type	VT-M16x ... A2/M	VT-M16x ... A2
Switching Current	5 A	
Minimum Switching Current	10 mA	
Voltage	250 V AC 48 V DC	
Switching Cycles	30.000	
Contact Type	Normally Closed Normally Open	
Temperature Range	Up to + 175°C	Up to + 120 °C
Tolerance	± 5 °C	
Differential	7 - 60 K	
Protection Class	IP 68	IP 65
Mounting	Brass fitting / Steel flange	Plastic fitting / Steel flange
Cable	Temperature resistant cables up to 5 m with PTFE Protection	
Weight	ca. 100 g	

Other versions according to customer specifications (e.g. IP69k) available upon request.

By installing the sensor directly above the engine, the response time can be reduced to 15 seconds.

firedect GmbH

**Leibnizstr. 4 72202
Nagold Germany**

T +49 7052 816 130 - 0

F +49 7052 816 130 - 9

E info@firedect.de

W www.firedect.de